

Premium Booth 3mW x 3mD Left side Corner Booth

SD-A-9-L Cnr
3mW x 3mD x 3.5mH

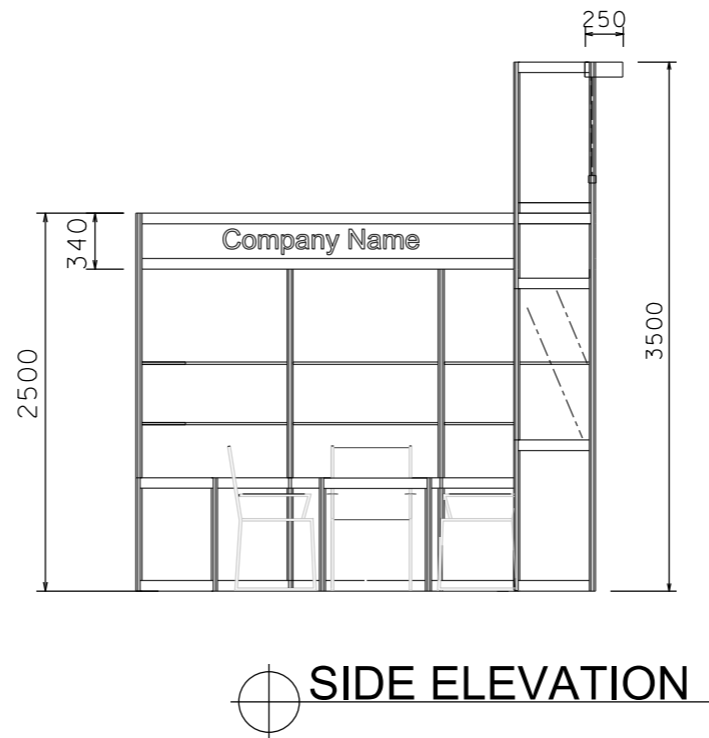
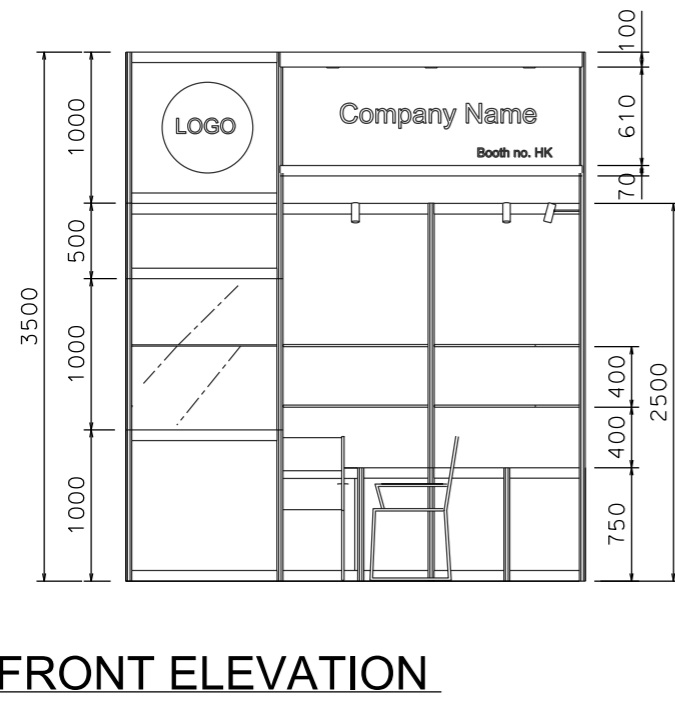
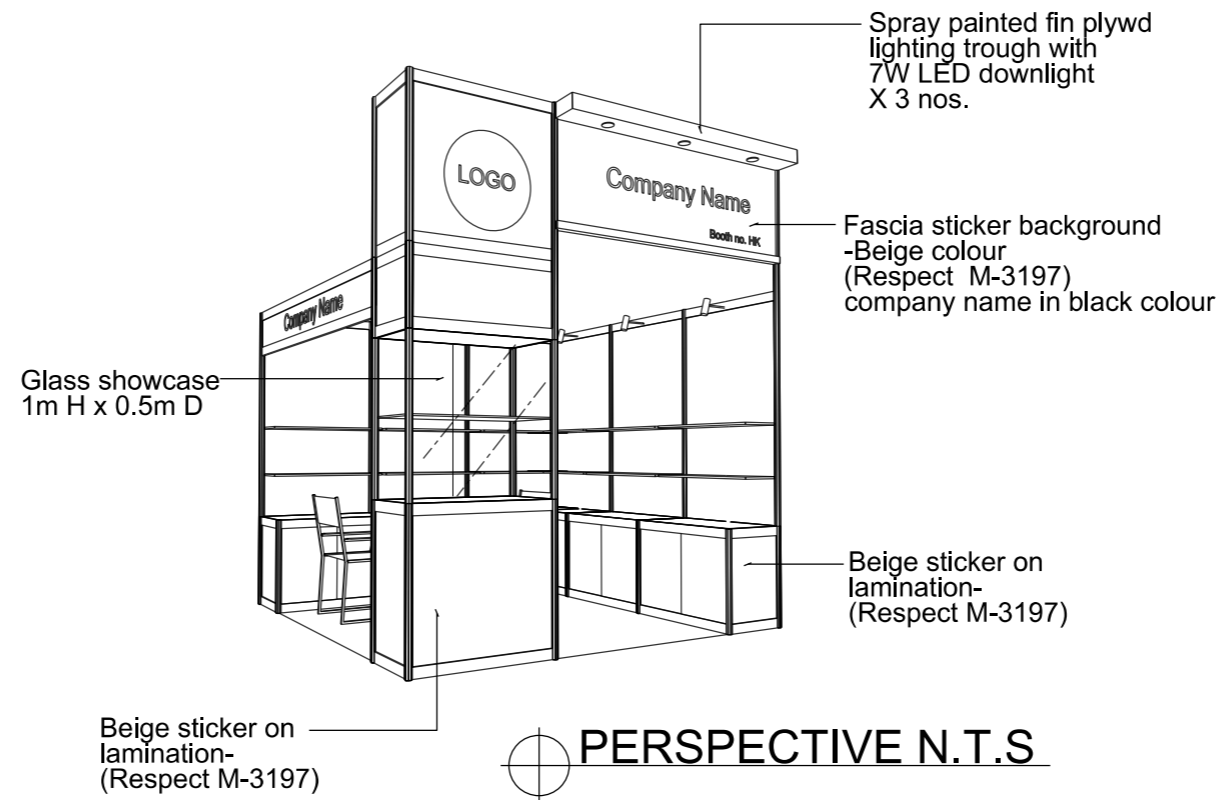
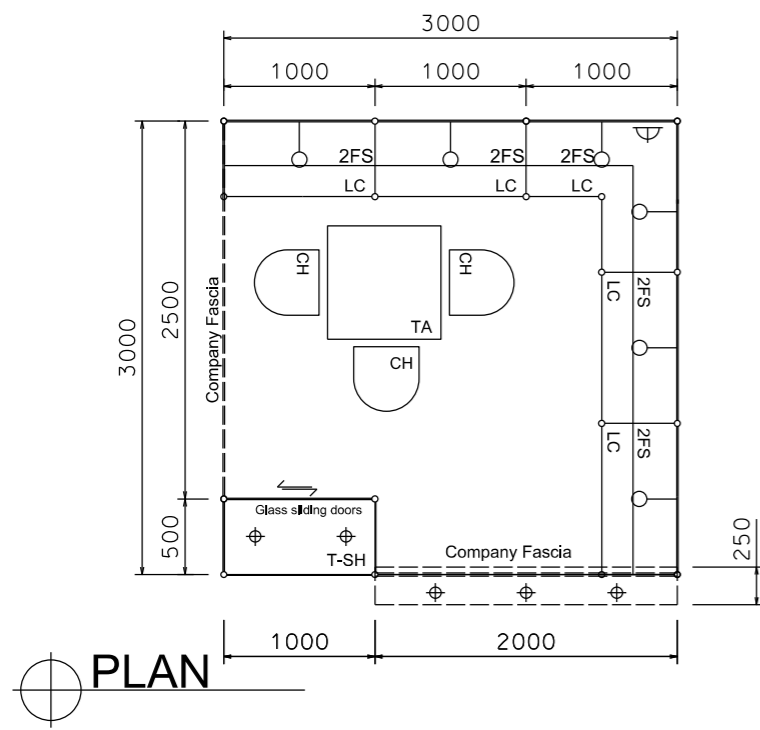

BOOTH SPECIFICATION		QTY
	Tall showcase in beige sticker lamination, 1 layer of glass shelf, 2x 7W LED downlights	1
	Lockable cabinet in beige sticker lamination (1mL x 0.5mD x 0.75mH)	5.5
	Wooden shelf (flat) (1mL x 0.3mD)	12
	Square meeting table (0.7m X0.7m x 0.75mH)	1
	Black leather chair	3
	13W LED Lamp Longarmed Spotlight (yellow)	6
	7W LED light (for fascia)	3
	500w Square pin power socket	1
	Company Logo	1

FILE PATH - L:\Local Fair Premium Booth 2011\SD-Layouts\SD-A layout\SD-A-Layout-New.dgn



NOTES UNLESS OTHERWISE SPECIFIED ALL DIMENSIONS ARE IN MM.

.....

.....

REVISION
 26-11-08
 15-12-08
 31-12-2008
 15-01-2009
 09-02-2009
 18-05-2009
 15-07-2009
 21-01-2010
 05-05-2015
 08-01-2019

DATE: 08-01-2019
 SCALE: 1 : 50 (A3)
 DRAWN BY: ..
 CHECKED BY:

TITLE
 Premium Booth
 SD-A-9-L
 Corner

PROJECT
 PREMIUM BOOTH
 3m x 3m Corner
 DATE: XXXXXXXX

SHEET
 SD-A01a