

# Premium Booth 10mW x 3mD One side open

SD-A-30  
10mW x 3mD x 3.5mH

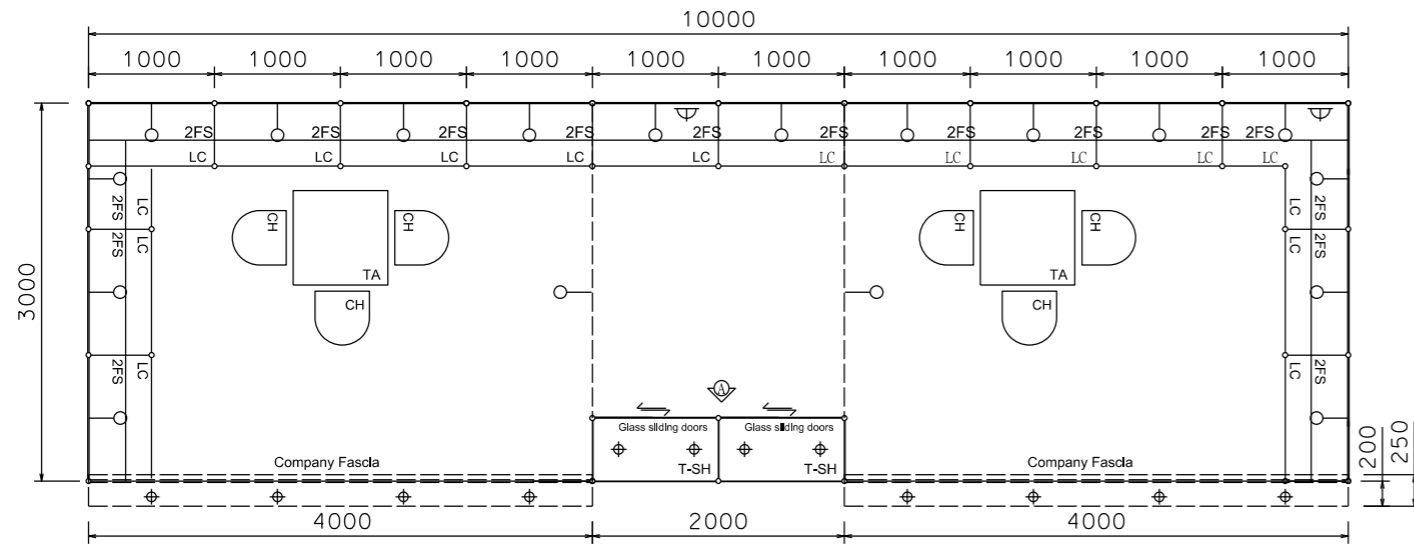

PLAN

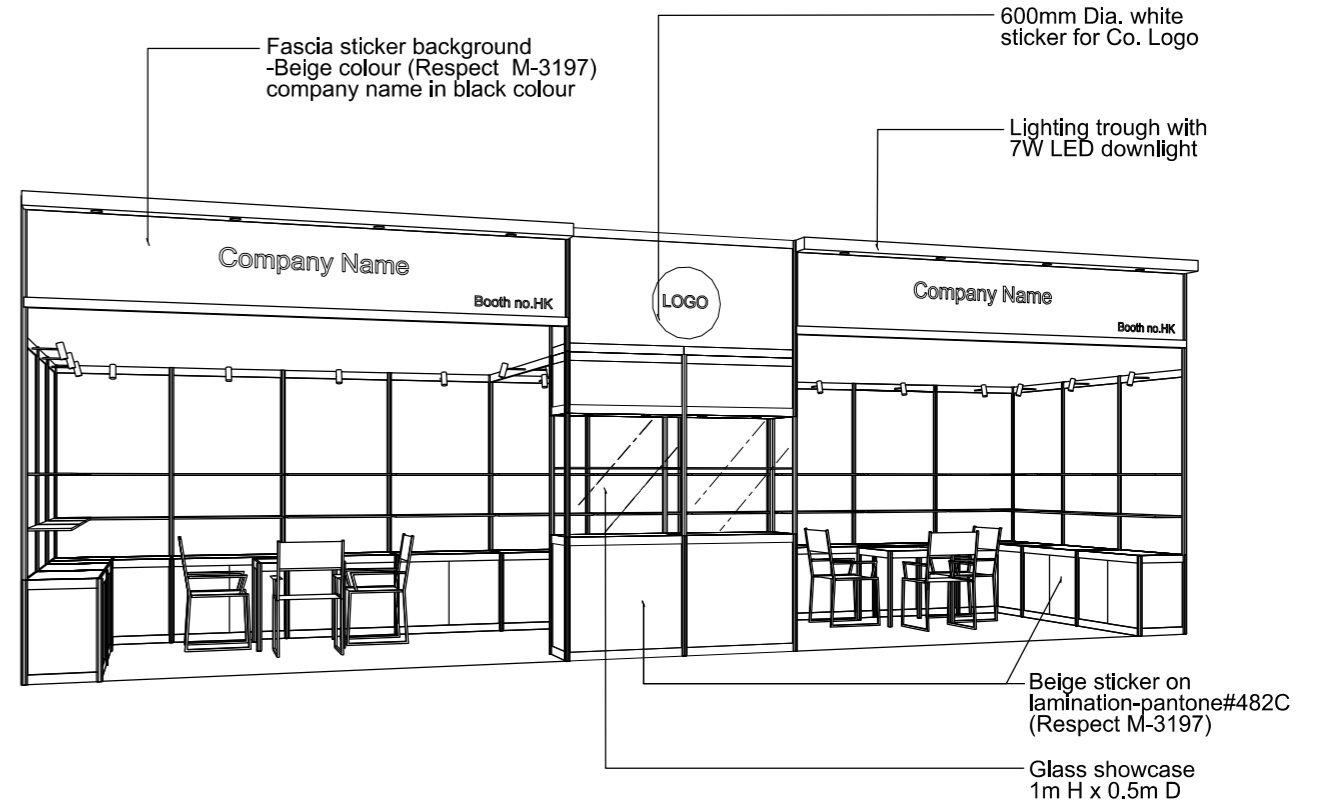

PERSPECTIVE N.T.S

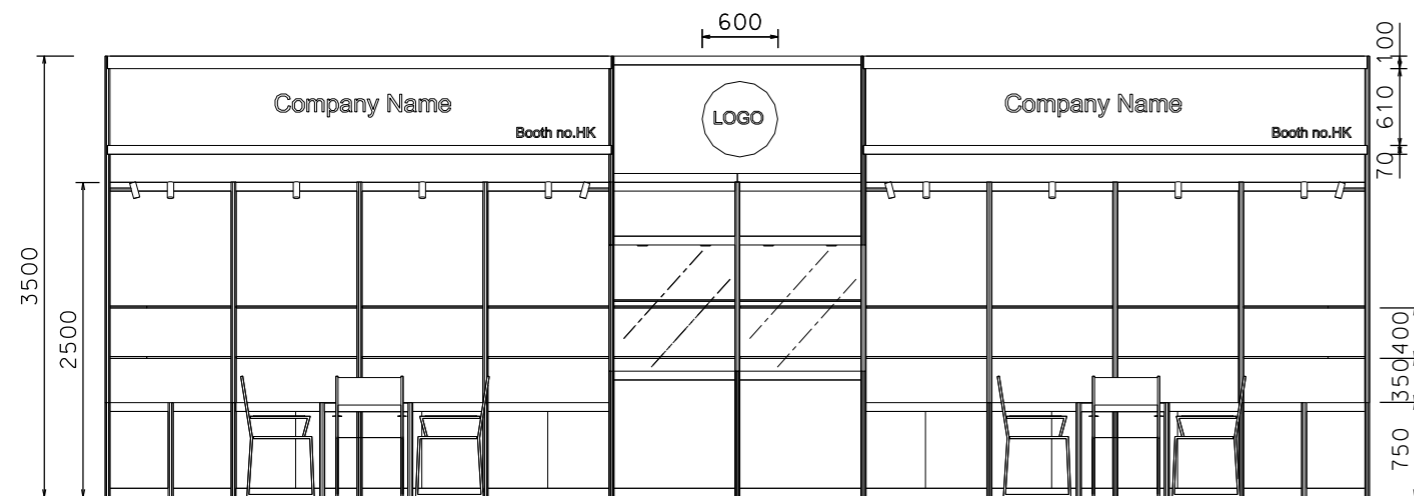

FRONT ELEVATION

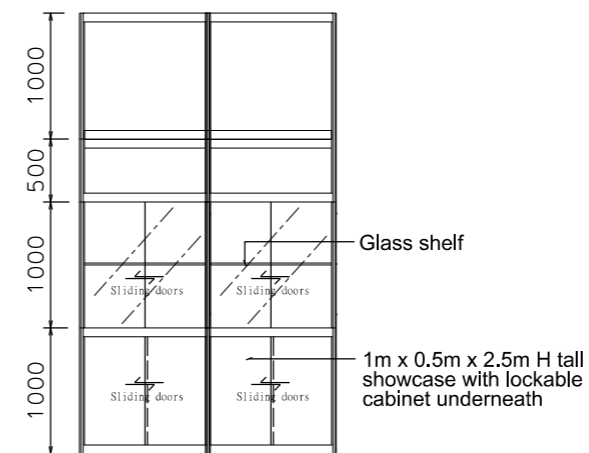

VIEW A

BOOTH SPECIFICATION		QTY
	Tall showcase in beige sticker lamination, 1 layer of glass shelf, 2x 7W LED downlights	2
	Lockable cabinet in beige sticker lamination (1mL x 0.5mD x 0.75mH)	15
	Wooden shelf (flat) (1mL x 0.3mD)	32
	Square meeting table (0.7m X 0.7m x 0.75mH)	2
	Black leather chair	6
	13W LED Lamp Longarmed Spotlight (yellow)	18
	7W LED light (for fascia)	8
	500w Square pin power socket	2
	Company Logo	1

FILE PATH - L:\Local Fair Premium Booth 2011\SD\SD-Layouts\SD-A-Layout\_New.dgn



## NOTES

UNLESS OTHERWISE SPECIFIED ALL DIMENSIONS ARE IN MM.

.....  
.....  
.....

## REVISION

19/11/2012  
08-01-2019

DATE: 08-01-2019

SCALE: 1 : 60 (A3)

DRAWN BY: ..

CHECKED BY: .....

## TITLE

Premium Booth  
SD-A-30

## PROJECT

PREMIUM BOOTH  
10m x 3m

DATE: XXXXXXXX

## SHEET

SD-A11