

# Premium Booth 3mW x 3mD One side open

SD-D-9  
3mW x 3mD x 3.5mH

## IMPORTANT NOTICE AMENDMENT OF BOOTH LIGHTING SPECIFICATIONS

ALL LIGHTS SPECIFIED AS 23 WATT ENERGY SAVING LAMPS (BOTH SPOTLIGHT/LONGARMED) ON THIS DRAWING WILL BE CHANGED TO **13 WATT LED LAMPS**, WITH EFFECT ON THE 1<sup>st</sup> of JANUARY 2019.



COLOUR PERSPECTIVE N.T.S

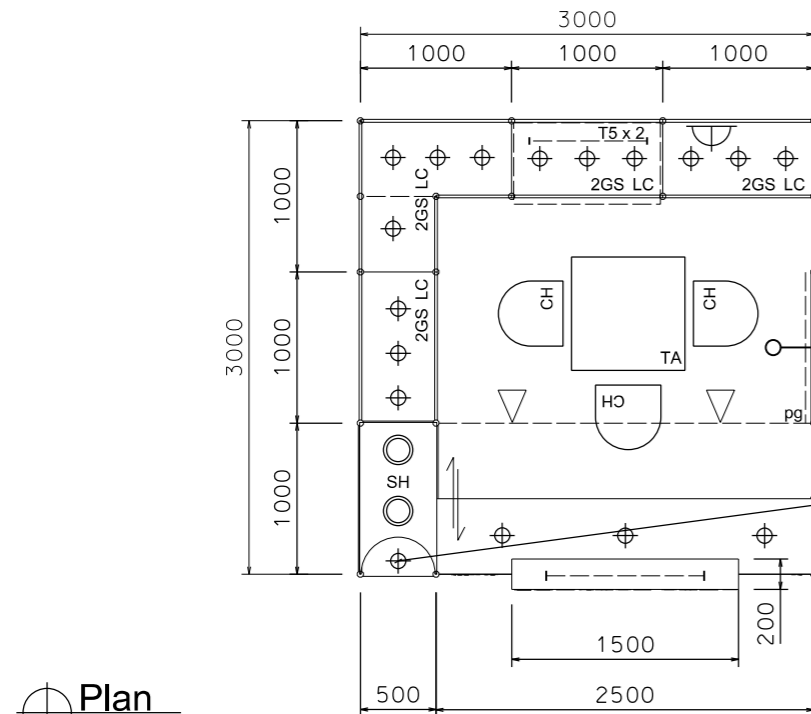

1 x 50w halogen uplight for upper part,  
1 x 50w halogen downlight for lower part

Plan

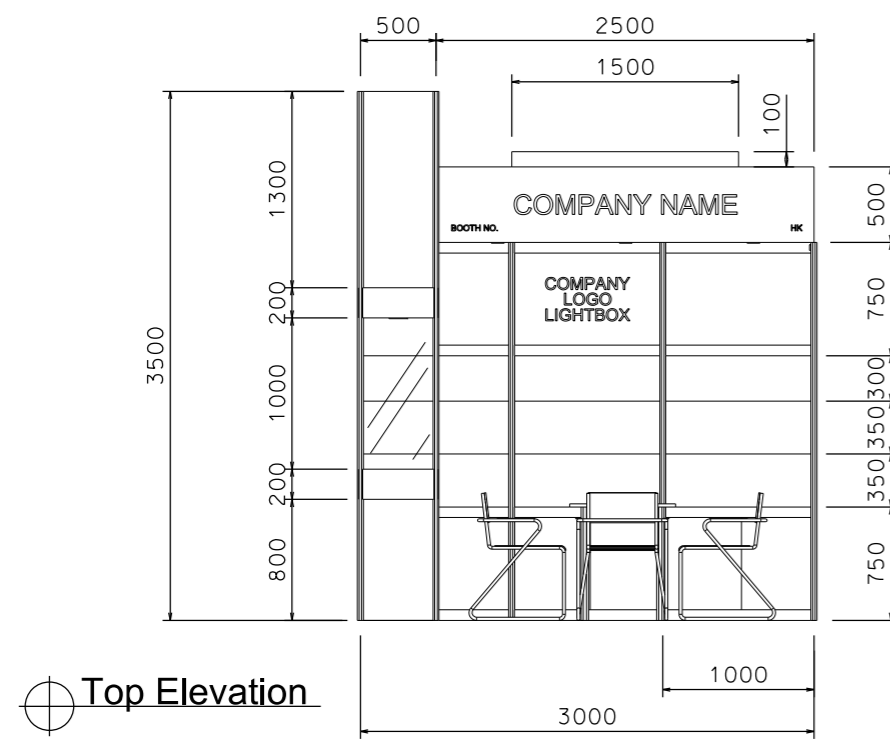

Top Elevation

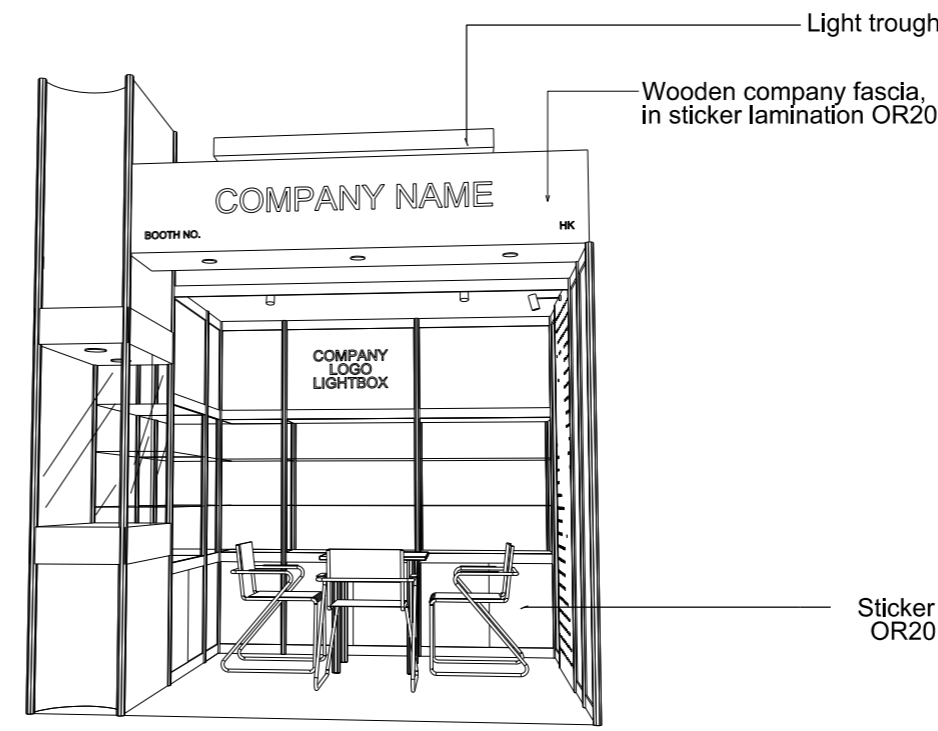

PERSPECTIVE N.T.S

BOOTH SPECIFICATION	QTY
Front glass showcase in light orange sticker lamination with glass sliding door. 2 x (100W) recess downlight & 2 x (50w) uplight and downlight	1
Company Logo Lightbox w/ 2 x T5 tube (1mL)	1
Tall showcase in light orange sticker lamination (without glass door), w/ 2 layers glass shelf, 3x50w halogen downlight, cabinet underneath (1mW x 0.5mD x 2.5mH)	4.5
Square meeting table (0.7m X0.7m x 0.75mH)	1
Black leather chair	3
Pegboard w/ 30 hooks ( 2.5mH)	1
Longarmed spotlight w/23 watt energy saving lamp (yellow)	1
Spotlight w/ 23w energy saving lamp (Yellow)	2
T5 tube inside light trough	1
500w Square pin power socket	1
50w halogen downlight (under fascia)	3

FILE PATH - L:\Local Fair Premium Booth 2011\SD-Layouts\SD-D layout\SD-D-2dLay-out-update.dgn



**NOTES** UNLESS OTHERWISE SPECIFIED ALL DIMENSIONS ARE IN MM.

.....

.....

.....

REVISION  
01/04/2011  
05-05-2015

DATE: 05-05-2015  
SCALE: 1 : 50 (A3)  
DRAWN BY: ..  
CHECKED BY: .....

TITLE  
Premium Booth SD-D-9 3x3

PROJECT  
PREMIUM BOOTH  
DATE: XXXXXXXX

SHEET  
SD-D01

# Premium Booth 3mW x 3mD Left Corner Booth

SD-D-9-L-Cnr  
3mW x 3mD x 3.5mH

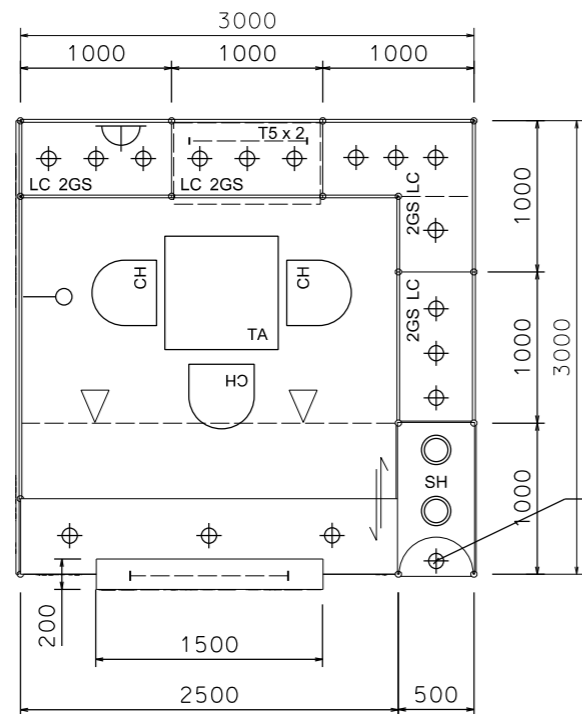

Plan

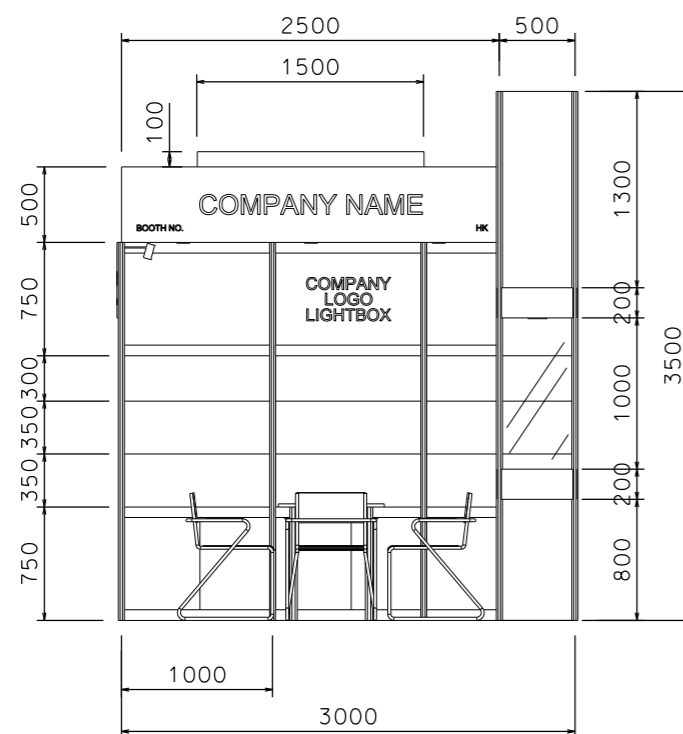

Top Elevation

## IMPORTANT NOTICE AMENDMENT OF BOOTH LIGHTING SPECIFICATIONS

ALL LIGHTS SPECIFIED AS 23 WATT ENERGY SAVING LAMPS (BOTH SPOTLIGHT/LONGARMED) ON THIS DRAWING WILL BE CHANGED TO **13 WATT LED LAMPS**, WITH EFFECT ON THE 1<sup>ST</sup> OF JANUARY 2019.

1 x 50w halogen uplight for upper part,

1 x 50w halogen downlight for lower part

Light trough

Wooden company fascia, in sticker lamination OR20

wooden fascia in sticker lamination OR20  
Letter : Black color

Sticker OR20

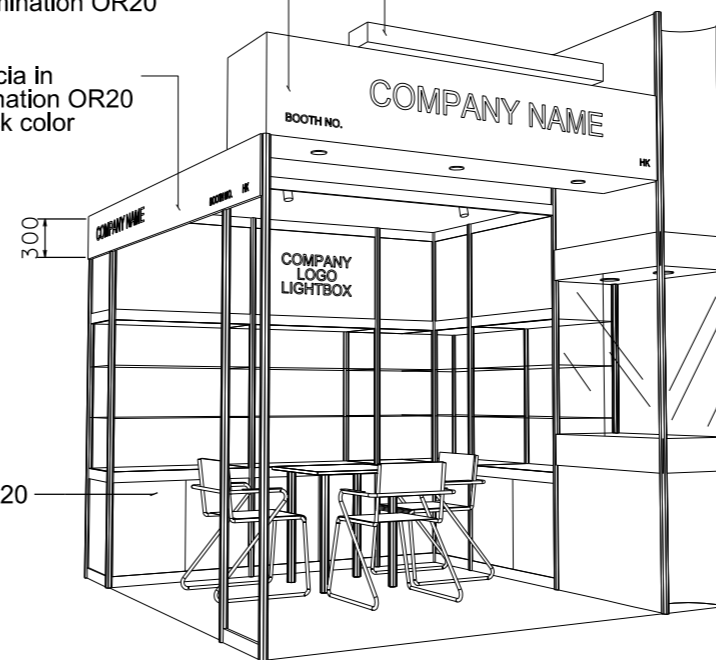

PERSPECTIVE N.T.S



COLOUR PERSPECTIVE N.T.S

BOOTH SPECIFICATION		QTY
	Front glass showcase in light orange sticker lamination with glass sliding door. 2 x (100W) recess downlight & 2 x (50w) uplight and downlight	1
	Company Logo Lightbox w/ 2 x T5 tube (1mL)	1
	Tall showcase in light orange sticker lamination (without glass door), w/ 2 layers glass shelf, 3x50w halogen downlight, cabinet underneath (1mW x 0.5mD x 2.5mH)	4.5
	Square meeting table (0.7m X0.7m x 0.75mH)	1
	Black leather chair	3
	Longarmed spotlight w/23 watt energy saving lamp (yellow)	1
	Spotlight w/ 23w energy saving lamp (Yellow)	2
	T5 tube inside light trough	1
	500w Square pin power socket	1
	50w halogen downlight (under fascia)	3

FILE PATH - L:\Local Fair Premium Booth 2011\SD-Layouts\SD-D-2dLay-out-update.dgn



NOTES UNLESS OTHERWISE SPECIFIED ALL DIMENSIONS ARE IN MM.

.....  
.....  
.....

.....  
.....  
.....

REVISION  
01/04/2011

DATE: 2010 07 06

SCALE: 1 : 50 (A3)

DRAWN BY: ..

CHECKED BY: .....

TITLE

Premium Booth  
SD-D-9-L-Cnr

PROJECT

PREMIUM BOOTH

DATE: XXXXXXXX

SHEET

SD-D01a

# Premium Booth 3mW x 3mD Right Corner Booth

SD-D-9-R-Cnr  
3mW x 3mD x 3.5mH

## IMPORTANT NOTICE AMENDMENT OF BOOTH LIGHTING SPECIFICATIONS

ALL LIGHTS SPECIFIED AS 23 WATT ENERGY SAVING LAMPS (BOTH SPOTLIGHT/LONGARMED) ON THIS DRAWING WILL BE CHANGED TO **13 WATT LED LAMPS**, WITH EFFECT ON THE 1<sup>ST</sup> OF JANUARY 2019.



COLOUR PERSPECTIVE N.T.S.

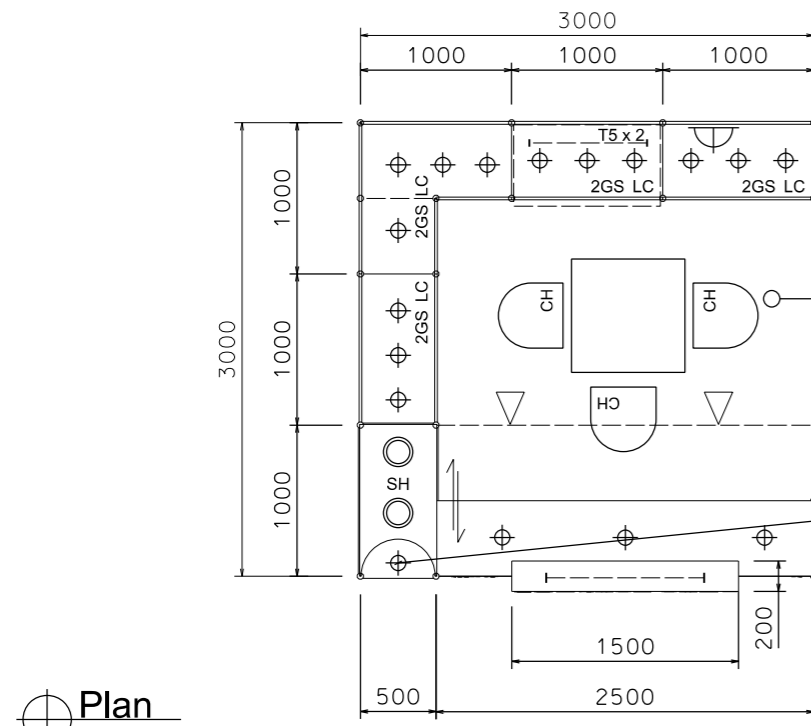

1 x 50w halogen uplight for upper part,  
1 x 50w halogen downlight for lower part

Plan

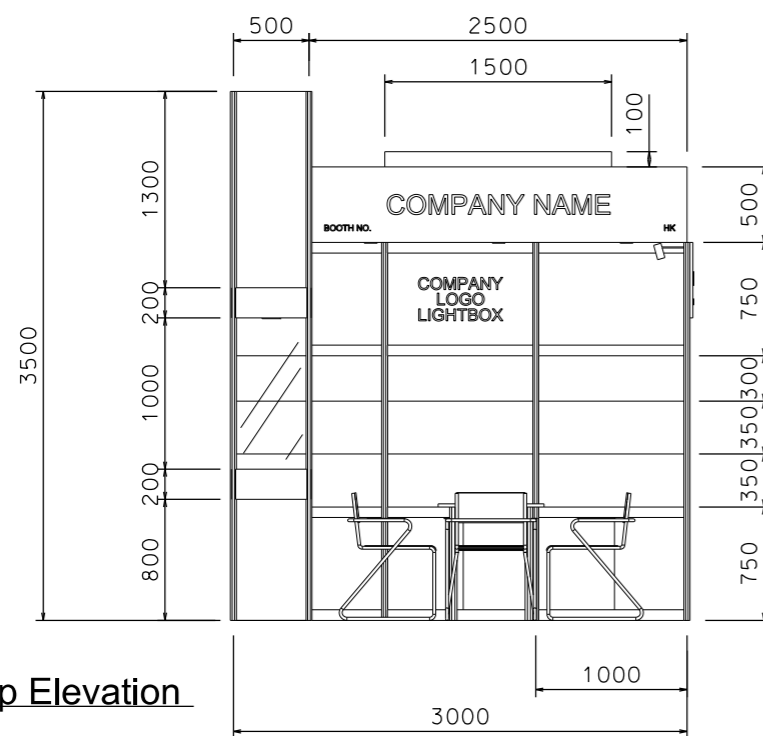

Top Elevation

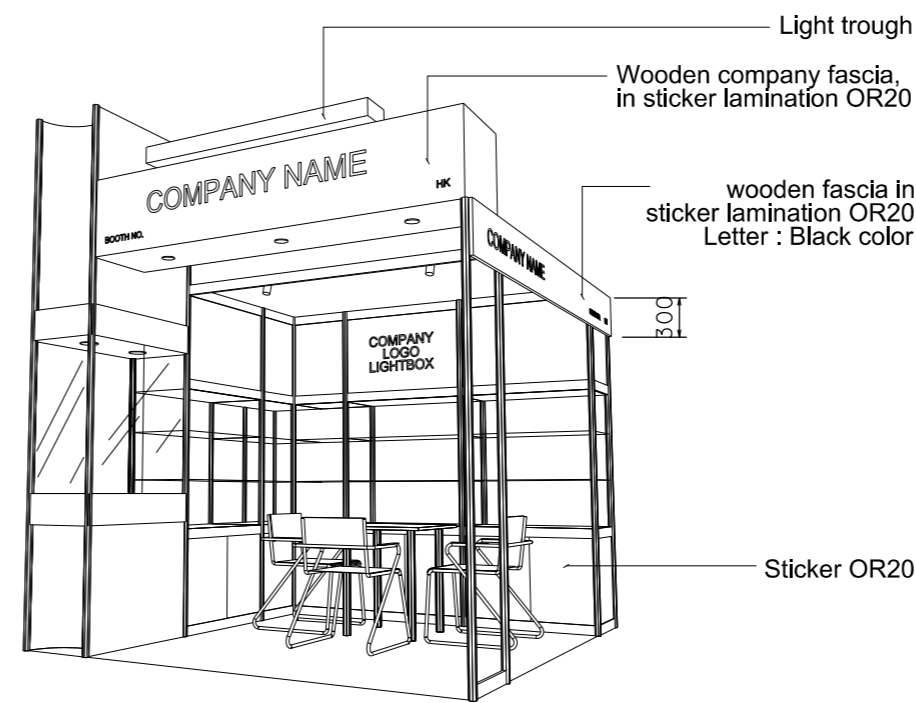

PERSPECTIVE N.T.S.

BOOTH SPECIFICATION		QTY
	Front glass showcase in light orange sticker lamination with glass sliding door. 2 x (100W) recess downlight & 2 x (50w) uplight and downlight	1
	Company Logo Lightbox w/ 2 x T5 tube (1mL)	1
	Tall showcase in light orange sticker lamination (without glass door), w/ 2 layers glass shelf, 3x50w halogen downlight, cabinet underneath (1mW x 0.5mD x 2.5mH)	4.5
	Square meeting table (0.7m X0.7m x 0.75mH)	1
	Black leather chair	3
	Longarmed spotlight w/23 watt energy saving lamp (yellow)	1
	Spotlight w/ 23w energy saving lamp (Yellow)	2
	T5 tube inside light trough	1
	500w Square pin power socket	1
	50w halogen downlight (under fascia)	3

FILE PATH - L:\Local Fair Premium Booth 2011\SD-Layouts\SD-D-2dLAYOUT-update.dgn



NOTES UNLESS OTHERWISE SPECIFIED ALL DIMENSIONS ARE IN MM.

.....  
.....  
.....

REVISION 01/04/2011

DATE: 2010 07 06  
SCALE: 1 : 50 (A3)  
DRAWN BY: ..  
CHECKED BY: .....

TITLE  
Premium Booth SD-D-9-R-Cnr

PROJECT  
PREMIUM BOOTH  
DATE: XXXXXXXX

SHEET  
SD-D01b